

內徑車刀 Micro Bar-Boring

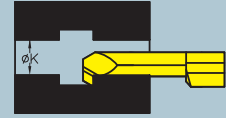

型號 EDP NO.	ØK	F	W/F/03	L2	L	r	S	ØD	在庫 stock	適用套筒 Applicable Sleeve
37.4010-1502	4	3.5	1.5	10	40	0.1	0.8	4	●	SP.250-04** SP.5650-04**
37.4015-1502	4	3.5	1.5	15	45	0.2	0.8	4	●	
37.5012-1502	5	3.8	1.5	12	45	0.1	1.2	4	●	
37.5018-1502	5	3.8	1.5	18	50	0.2	1.2	4	●	
37.6015-2002	6	4.8	2.0	15	50	0.2	1.5	6	●	SP.250-06** SP.5650-06**
37.6022-2002	6	4.8	2.0	22	55	0.2	1.5	6	●	
37.7020-2002	7	5.8	2.0	20	55	0.2	2.0	6	●	
37.7025-2002	7	5.8	2.0	25	60	0.2	2.0	6	●	
37.8020-2002	8	6.8	2.0	20	60	0.2	2.5	8	●	SP.250-08** SP.5650-08**
37.8035-2002	8	6.8	2.0	30	65	0.2	2.5	8	●	
37.10030-3002	10	8.5	3.0	30	75	0.2	2.5	10	●	SP.250-10** SP.5650-10**
37.10040-3002	10	8.5	3.0	40	85	0.2	2.5	10	●	

無"●"標示者為訂製品。Without "●" marking means custom products.
 有"●"標示者為在庫品。With "●" marking means items in stock.

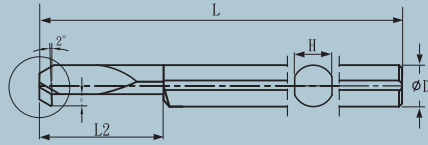
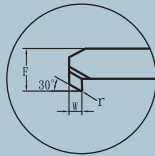
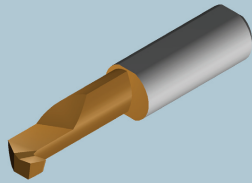

内徑車刀 Micro Bar-Boring

TW

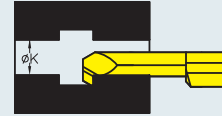
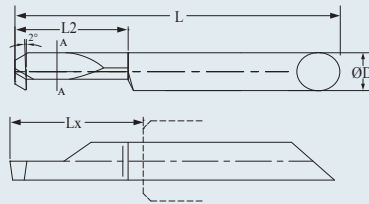
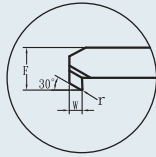
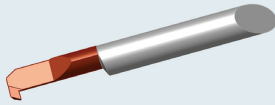

ATW 内冷式

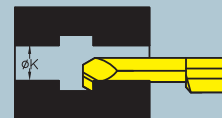
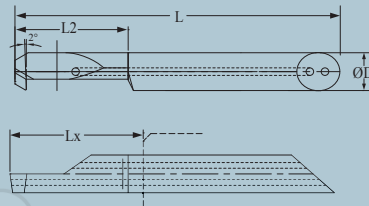
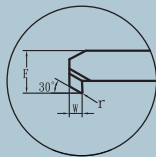
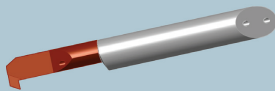

型號 EDP NO.	内冷式 型號 EDP NO.	ØK	F	W ØF0.03	L2	Lx	r	S	ØD	在庫 stock	適用套筒 Applicable Sleeve
TW 37.4010-1502	ATW 37.4010-1502	4	3.8	1.5	10	12	0.2	0.8	4		SP.380-04**
TW 37.4015-1502	ATW 37.4015-1502	4	3.8	1.5	15	17	0.2	0.8	4		SP.380-04**
TW 37.5012-1502	ATW 37.5012-1502	5	4.8	1.5	12	15	0.2	1.2	5		SP.380-05**
TW 37.5018-1502	ATW 37.5018-1502	5	4.8	1.5	18	21	0.2	1.2	5		SP.380-05**
TW 37.6015-2002	ATW 37.6015-2002	6	5.8	2.0	15	18	0.2	1.5	6		SP.380-06**
TW 37.6022-2002	ATW 37.6022-2002	6	5.8	2.0	22	25	0.2	1.5	6		SP.380-06**
TW 37.7020-2002	ATW 37.7020-2002	7	6.8	2.0	20	23	0.2	2.0	7		SP.380-07**
TW 37.7025-2002	ATW 37.7025-2002	7	6.8	2.0	25	28	0.2	2.0	7		SP.380-07**
TW 37.8020-2502	ATW 37.8020-2502	8	7.8	2.5	20	23	0.2	2.5	8		SP.380-08**
TW 37.8030-2502	ATW 37.8030-2502	8	7.8	2.5	30	33	0.2	2.5	8		SP.380-08**

無"●"標示者為訂製品。Without "●" marking means custom products.
 有"●"標示者為在庫品。With "●" marking means items in stock.